

SMITH & NOBLE

Step by Step Installation Instructions

Turned Wood Traversing Hardware

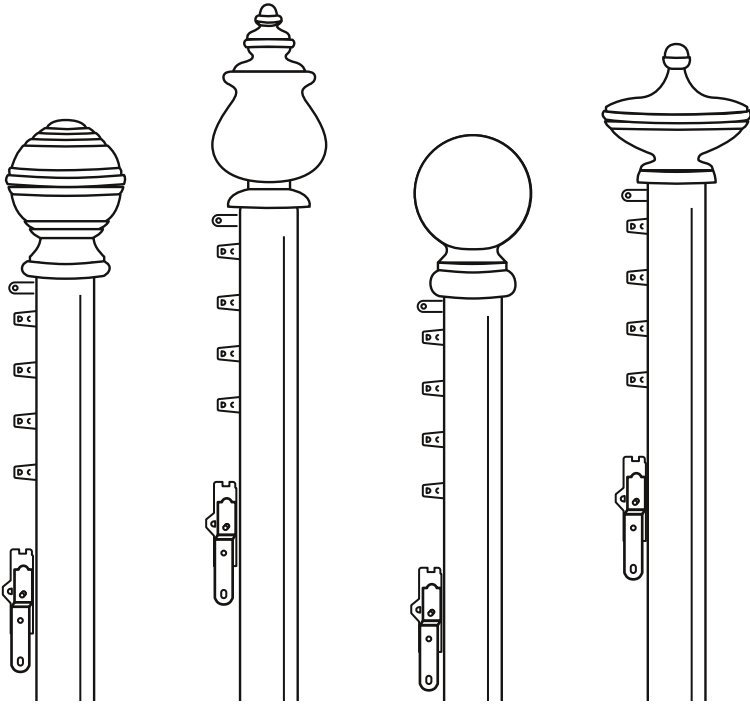

Wall Mount
Single Traversing Rod Set

Everything You Need

A Smooth Set-Up

We want you to love your new hardware and that includes having a smooth installation experience. If you encounter any difficulties or questions, please reach out to us for help. It's why we're here. Call us at 800.248.8888 or visit www.smithandnoble.com/knowhow for more info on installation.

We recommend you hold on to all packaging until your hardware is fully installed. Should something go wrong (we strongly doubt it), we want any potential returns to be a painless as possible.

Customer Service Hours

Monday – Friday: 6am – 7pm PT

Saturday – Sunday: 7am – 4pm PT

smithandnoble.com



Table of Contents

<i>Step 1 -</i>	Getting Started	3
	Parts & Tools	3
<i>Step 2 -</i>	Installing Hardware	4 - 6
	Installing Finials to Rod	4
	Center Support Bracket	4
	Connecting Spliced Rods	5
	Mounting Center Support Bracket on Rod	6
	Installing Mounting Brackets	6
	Place Rod into Mounting Brackets	6
	Installing Center Support Bracket to Wall	6
<i>Optional -</i>	Care & Cleaning	Back Cover
	Warranty	Back Cover

Step 1 – Getting Started

Parts and Tools

Before you begin, check the accompanying diagram to make sure you have all the parts you need. You'll need to make sure the surface you intend to install your hardware is sturdy enough to accommodate the brackets. If you're screwing directly into a surface this means locating wood studs that are strong enough to securely bond with the included screws. Otherwise, you'll need to use a secure fastener (as illustrated) but please note this piece is not included.



WALLBOARD OR PLASTER: Hollow wall applications: Use a secure fastener designed specifically for this purpose.

METAL: Prepare by pre-drilling holes and then using the included screws.

CONCRETE, STONE, BRICK OR TILE: Use a masonry drill and surface-specific plugs, anchors, or screws. When selecting a fastener be sure it's designed to support the weight of the product being installed (if you're not sure, either give us a call or ask a professional at your local hardware store). Once obtained, follow the fastener manufacturer's instructions regarding proper installation.

TOOLS YOU WILL NEED TO INSTALL YOUR HARDWARE: Pencil, screwdriver, 1/4" nut driver, level, and a drill with a 7/64" drill bit.

Note: It's important to monitor the amount of pressure you apply when using a drill. If the screws are too tight this may cause the screw itself to break off in the wall or window frame.

<p>SCREWS</p>	<p>STANDARD MOUNTING BRACKET</p>
<p>CENTER SUPPORT BRACKET</p>	<p>SCREW PLUGS</p>
<p>PENCIL & SCREWDRIVER (NOT INCLUDED)</p>	<p>POWER DRILL & LEVEL (NOT INCLUDED)</p>

Step 2 – Installing Hardware

Installing Finials to Rod

Simply screw (2) finials into end of pre-drilled rod provided.

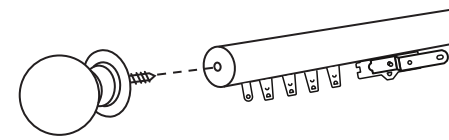

Center Support Bracket

NOTE - The Center Support Bracket used with the Wood Traverse Rod is to be mounted on top of the wood pole in an inverse position, unlike the two Standard Brackets which are mounted below the rod at each end of the rod.

Locate the Center Support Bracket(s). The Center Support Bracket will have a lower profile front edge (as compared to the standard mounting brackets) in order to allow the master carrier to slide past the center support bracket (see diagram to the left).

Using a Phillips head screwdriver, insert the screw in the hole on the back side of the cup of the Center Support Bracket and slightly turn until the point of the screw appears on the inside of the cup.

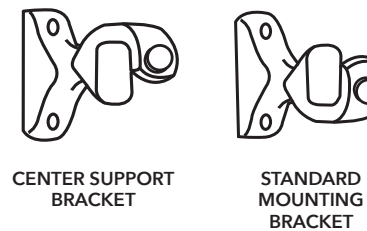
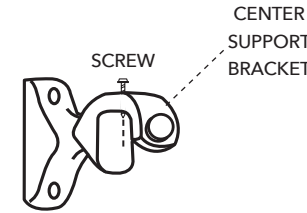

BRACKET MOUNTING TEMPLATES ENCLOSED SEPARATELY

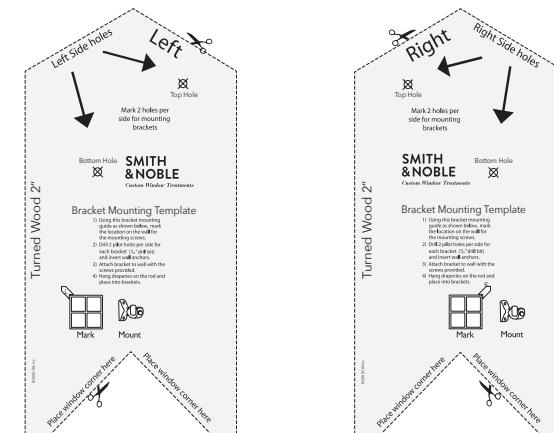

Connecting Spliced Rods

Locate the Traverse Rod segment with the aluminum track that extends beyond the end of the wood pole (Figure A). Place the two Traverse Rod segments end-to-end so the aluminum track that extends beyond the end of the wood pole fits inside the channel on the other wood pole segment (Figure B).

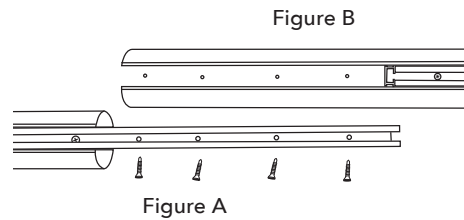

Align the pre-drilled holes in the aluminum track with the pre-drilled holes in the channel on the other wood pole segment. Locate the poly bag containing four (4) screws used to secure the track inside the channel. Place the screws in the holes on the aluminum track and tighten down using a Phillips head screwdriver.

DO NOT OVERTIGHTEN THE SCREW.

DO NOT USE A DRILL DRIVER TO TIGHTEN SCREWS!

Test the movement of the carriers between the two segments of aluminum track. Adjust screws if necessary to ensure a smooth movement of the carriers between the track segments.

Installing Mounting Brackets

Attach/mount the two Standard Mounting Brackets to the wall (secured to wall studs) to support the traverse rod - one bracket to be placed near each end of the pole - see the enclosed Standard Bracket Mounting Template for proper placement and installation of the standard brackets.

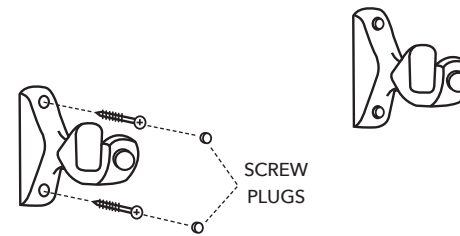

Place Rod into Mounting Brackets

Place the drapery rod in the standard mounting brackets that were mounted to the wall.

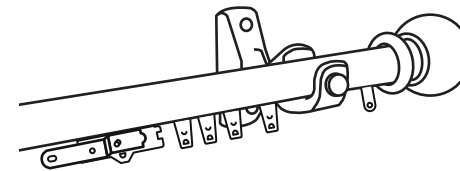

Install Center Support Bracket to Wall

Locate the two (2) wall mounting drywall screws used to secure the Center Support Bracket to the wall. Insert the screws through the two pre-drilled holes in the bracket and into the wall. The mounting screws should be attached securely into a wall stud.

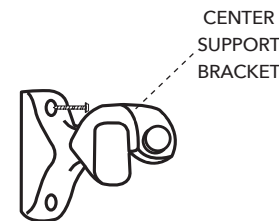

Mounting Center Support Bracket to Rod

Place the Center Support Bracket over the center of the wood rod. Hand-tighten the wood screw until the bracket is securely seated over the top of the rod.

DO NOT OVERTIGHTEN THE SCREW.

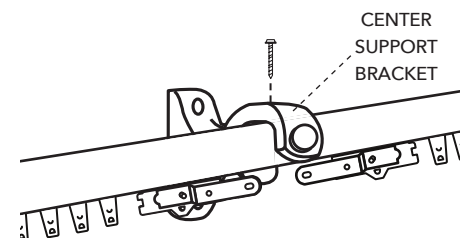

Care & Safety

Care & Cleaning

Minimal care and cleaning is needed to maintain the beauty of your Hardware.

To Vacuum: Use brush or dust head attachment.

To Dust: Use soft, clean cloth.

Warranty Service

The enjoyment of your hardware should be everlasting, which is why our products come with a limited lifetime warranty. The warranty applies to the original owner, requires a proof of purchase (hang on to your receipt!) and covers defects in material or craftsmanship. Hardware must have been properly installed. We reserve the right to determine if your hardware warrants a repair or a replacement. Visit smithandnoble.com/guarantee to see full details. In need of warranty service? Call us at 800.248.8888 and we'll arrange for a repair or replacement ASAP.
