

SMITH & NOBLE

Motivia®

Motorization Made Simple

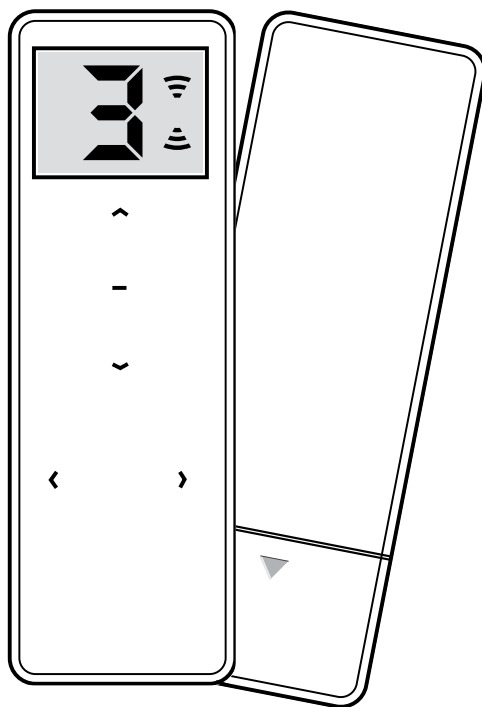

Durawood & Wood Blinds
With Motivia® Motorized Tilt

CAUTION: When setting limits on tilt products, be advised that setting the closure of the slats too tight can result in the breaking of the strings/ladders. Please use caution when adjusting the limits.

These directions are for programming a motor from a factory default state. If the blind has been programmed and other adjustments need to be made, additional directions will be at the end of the document. Please read entire document before programming.

STEP 1 - TO "PAIR" REMOTE TO THE A BLIND

1. Press the Programming Button on the motor with a paperclip for one jog.
2. Press P2 on the remote. (*Blind will jog.*)
3. Press P2 on the remote. (*Blind will jog.*)
4. Press UP or DOWN arrow. (*Blind will jog.*)

The remote will now work with the blind.

STEP 2 - LIMIT SETTING MODE

1. Press P2 on the remote. (*Blind will jog.*)
2. Press the UP arrow on the remote. (*Blind will jog.*)
3. Press P2 on the remote. (*Blind will jog.*)

STEP 3 - SETTING LIMITS

1. Move blind to the desired Opened/Closed position, STOP the blind and continue to hold STOP until the blind jogs. The Limit is now set. (*Please make sure not to close the slats too tight.*)
2. Move blind to the desired Opened/Closed position, STOP the blind and continue to hold STOP until the blind jogs. The limit is now set. (*Please make sure not to close the slats too tight.*)
3. If limits need to be adjusted after setting, go back to "LIMIT SETTING MODE" and follow "SETTING-LIMITS".

STEP 4 - SETTING 3RD LIMIT, "FAVORITES POSITION"

1. Move blind to the desired FAVORITES Position.
2. Press P2 on the remote. (*Blind will jog.*)
3. Press STOP on the remote. (*Blind will jog.*)
4. Press STOP on the remote. (*Blind will jog.*)

To activate 3rd limit, press the STOP button for approximately 2 seconds. Blind will move to the set position. The FAVORITES stop is set.

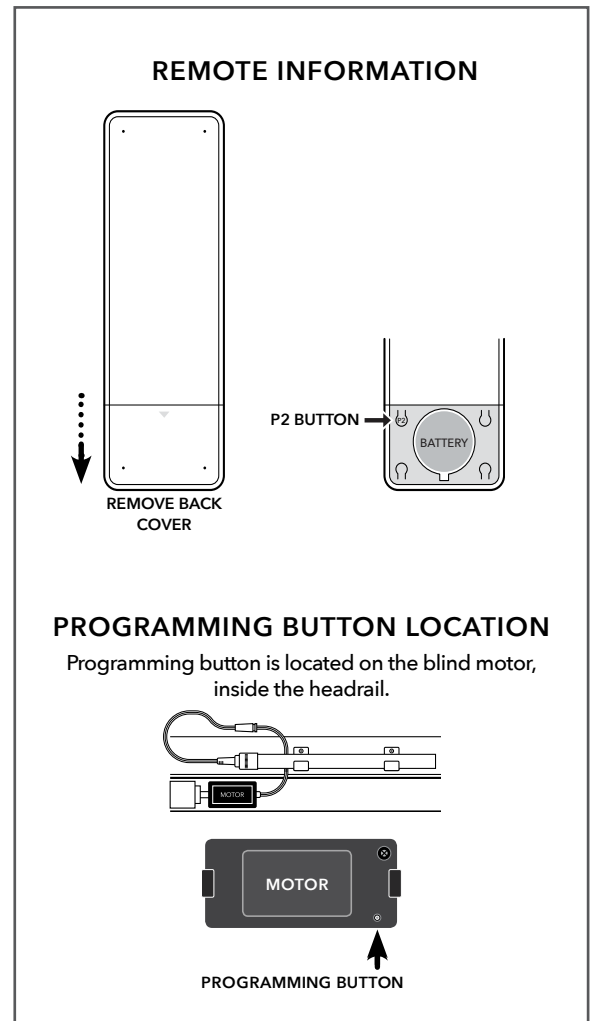

STEP 5 - TO REMOVE 3RD LIMIT, "FAVORITES POSITION"

1. Press STOP button for about 5 seconds, blind will move to Favorites Position.
2. Press P2 on the remote. (*Blind will jog.*)
3. Press STOP button on the remote. (*Blind will jog.*)
4. Press STOP button on the remote. (*Blind will jog.*)

3rd limit is now removed.

STEP 6 - ACTIVATE THE TILT FUNCTION

1. Press P2 on the remote. (*Blind will jog.*)
2. Press the UP arrow on the remote. (*Blind will jog.*)
3. Press the DOWN arrow on the remote. (*Blind will jog.*)

Now the slats on the blind will tilt by tapping the arrows on the remote. Holding the arrows longer will make the blind operate in regular mode. To remove the tilting function, use same process as activating.

STEP 7 - ADDING A REMOTE

Start with the Original Remote that currently works the blind.

1. Press P2 on the Original Remote. (*Blind will jog.*)
2. Press P2 on the Original Remote. (*Blind will jog.*)
3. Press P2 on the New Remote. (*Blind will jog.*)

STEP 8 - REMOVING A REMOTE

1. Press P2 on the Original Remote.
2. Press P2 on the Original Remote.
3. Press P2 on the New Remote.

STEP 9 - REPLACING A LOST REMOTE

If blind has been previously programmed but the remote has been lost:

1. Press the PROGRAMMING Button on the motor for 1 jog.
2. Press the UP & DOWN arrows on the new remote. (*Blind will jog.*)

The new remote has been added to the blind. The blind will have the same settings as with the previous remote.